

Grandezze - Size :
25-16, 25-19, 32-16, 32-20, 40-16, 40-20, 50-16, 50-20

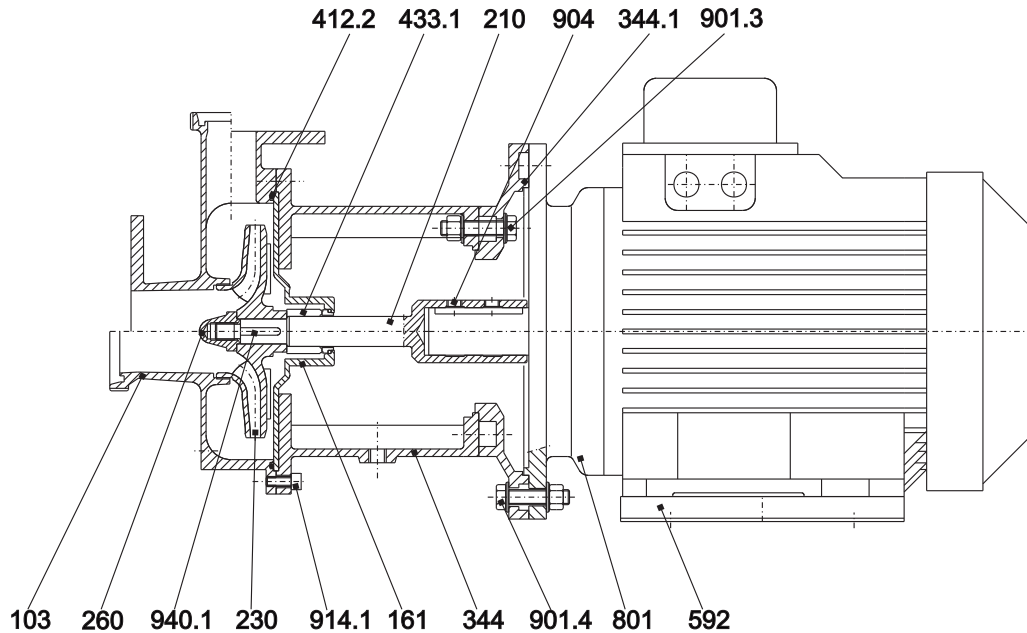

Grandezze - Size:
65-16, 65-20, 80-16, 80-20

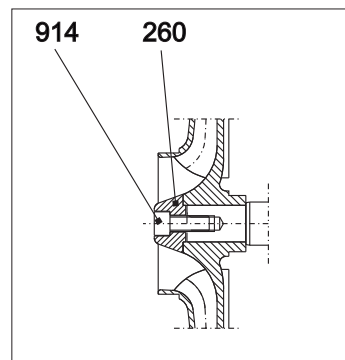

N.	DESCRIZIONE	DESCRIPTION
103	Corpo	Casing
161	Coperchio del corpo	Casing cover
210	Albero	Shaft
230	Girante	Impeller
260	Ogiva girante	Impeller hub
344	Lanterna motore	Lantern bracket
344.1	Flangia di riduzione	Reduction flange
412.2	O.Ring	O.Ring
433.1	Tenuta meccanica	Mechanical seal
592	Piede motore	Electric motor foot
801	Motore elettrico	Electric motor
901.3	Vite T.E con dado	Hex head screw with nut
901.4	Vite T.E. con dado	Hex head screw with nut
904	Grano	Locking screw
914	Vite ogivale	Screw
914.1	Vite ogivale	Screw
940.1	Linguetta girante	Impeller key